

POCKET PAR 400

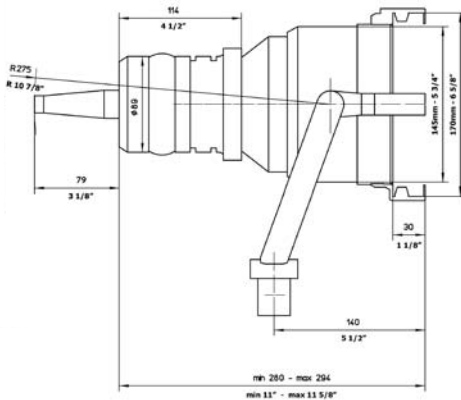
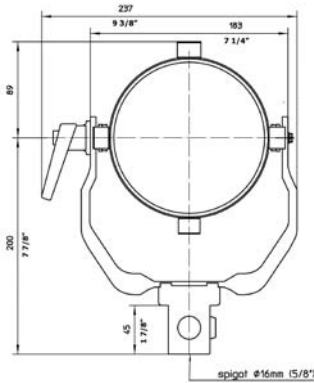

Dimensions are for POCKET PAR 400

Cat. No.	Description
504500	POCKET PAR 400
504501	POCKET LITE 400
504502	25 ft. Head/Ballast Cable
504503	50 ft. Head/Ballast Cable
531610	Four Leaf Barndoor
531615	Eight Leaf Barndoor
502325	Lens Set (Spot, Medium, Wide, Super Wide, Frosted)
502323	Lens Bag
504545	400W Single Ended HMI Lamp
531650	6 5/8" Full Single Scrim
531652	6 5/8" Full Double Scrim
571712	Scrim Bag
504521	3/4" CTO Glass Filter
504553	Tubolite Pipe w/ Case
531658	6 5/8" Chimera Speed Ring
571159	Chimera Video Pro Bank, Small
504557	Chimera Lantern Adapter
504558	Chimera 20" Lantern
571661	Hand Grip
504511	Lighthouse Assembly, Clear
504512	Lighthouse Assembly, Frosted
502513	Lighthouse Stirrup
504514	Shutter
504559	Source 4™ Adapter Set
853276	Safety Cable
504806	400/575W Electronic Ballast w/ALF
504807	400/575W Electronic Ballast w/DMX & ALF
504808	200/400W DC Electronic Ballast
504596	Case for POCKET PAR/LITE 400 System
504595	Case for POCKET PAR/LITE 400 + Lighthouse System

Specifications

POCKET PAR	
Weight	6.1 lbs. (2.8 kg)
Reflector	Facetted dichroic glass
Lampholder	GZZ9.5
Mounting	5/8" (16 mm) stand mount
POCKET LITE	
Weight	6.3 lbs. (2.9 kg)
Reflector	Micro stippled dichroic glass
Lampholder	GZZ9.5
Mounting	5/8" (16 mm) stand mount

POCKET PAR 400 also available in Kits
See Kit Section for details

For Ballast Specifications see Ballast Section

POCKET PAR 400

Photometric Data: Footcandles

Distance	10 ft. (3.0 m)	15 ft. (4.6 m)	20 ft. (6.1 m)	25 ft. (7.6 m)
Super Spot/No Lens				
Spot (6°)	13401	5956	3350	2144
Spot Lens				
Spot (9°)	7526	3345	1881	1204
Medium (11°)	3825	1700	956	612
Flood (14°)	2800	1245	700	448
Medium Lens				
Spot (11° x 23°)	2750	1222	688	440
Medium (17° x 26°)	1545	687	386	247
Flood (21° x 29°)	1170	520	293	187
Wide Lens				
Spot (19° x 38°)	1093	486	273	175
Medium (32° x 47°)	523	232	131	84
Flood (41° x 56°)	353	157	88	56
Super Wide Lens				
Spot (40°)	645	287	161	103
Medium (50°)	323	143	81	52
Flood (62°)	227	101	57	36
Frosted Lens				
Spot (33°)	443	197	111	71
Medium (51°)	225	100	56	36
Flood (69°)	138	61	34	22

In addition to using spread lenses, POCKET PARS can be focused over a wide range. This data shows spot, medium and flood performance for each lens. The table showing "performance at any distance" is based on medium focus. For additional data see the Photometric Calculator at www.arri.de/prod/lighting/calculator

Photometric Data: Beam Diameter

Distance	10 ft. (3.0 m)	15 ft. (4.6 m)	20 ft. (6.1 m)	25 ft. (7.6 m)
Super Spot/No Lens				
Spot (6°)	1.0 ft. (0.3 m)	1.6 ft. (0.5 m)	2.1 ft. (0.6 m)	2.6 ft. (0.8 m)
Spot Lens				
Spot (9°)	1.6 ft. (0.5 m)	2.4 ft. (0.7 m)	3.1 ft. (0.9 m)	3.9 ft. (1.2 m)
Medium (11°)	1.9 ft. (0.6 m)	2.9 ft. (0.9 m)	3.9 ft. (1.2 m)	4.8 ft. (1.5 m)
Flood (14°)	2.5 ft. (0.8 m)	3.7 ft. (1.1 m)	4.9 ft. (1.5 m)	6.1 ft. (1.9 m)
Medium Lens				
Spot (11° x 23°)	1.9 x 4.1 ft.	2.9 x 6.1 ft.	3.9 x 8.1 ft.	4.8 x 10.2 ft.
	0.6 x 1.2 m	0.9 x 1.9 m	1.2 x 2.5 m	1.5 x 3.1 m
Medium (17° x 26°)	3.0 x 4.6 ft.	4.5 x 6.9 ft.	6.0 x 9.2 ft.	7.5 x 11.5 ft.
	0.9 x 1.4 m	1.4 x 2.1 m	1.8 x 2.8 m	2.3 x 3.5 m
Flood (21° x 29°)	3.7 x 5.2 ft.	5.6 x 7.8 ft.	7.4 x 10.3 ft.	9.3 x 12.9 ft.
	1.1 x 1.6 m	1.7 x 2.4 m	2.3 x 3.1 m	2.8 x 3.9 m
Wide Lens				
Spot (19° x 38°)	3.3 x 6.9 ft.	5.0 x 10.3 ft.	6.7 x 13.8 ft.	8.4 x 17.2 ft.
	1.0 x 2.1 m	1.5 x 3.1 m	2.0 x 4.2 m	2.6 x 5.2 m
Medium (32° x 47°)	5.7 x 8.7 ft.	8.6 x 13.0 ft.	11.5 x 17.4 ft.	14.3 x 21.7 ft.
	1.7 x 2.7 m	2.6 x 4.0 m	3.5 x 5.3 m	4.4 x 6.6 m
Flood (41° x 56°)	7.5 x 10.6 ft.	11.2 x 16.0 ft.	15.0 x 21.3 ft.	18.7 x 26.6 ft.
	2.3 x 3.2 m	3.4 x 4.9 m	4.6 x 6.5 m	5.7 x 8.1 m
Super Wide Lens				
Spot (40°)	7.3 ft. (2.2 m)	10.9 ft. (3.3 m)	14.6 ft. (4.5 m)	18.2 ft. (5.5 m)
Medium (50°)	9.3 ft. (2.8 m)	14.0 ft. (4.3 m)	18.7 ft. (5.7 m)	23.3 ft. (7.1 m)
Flood (62°)	12.0 ft. (3.7 m)	18.0 ft. (5.5 m)	24.0 ft. (7.3 m)	30.0 ft. (9.1 m)
Frosted Lens				
Spot (33°)	5.9 ft. (1.8 m)	8.9 ft. (2.7 m)	11.8 ft. (3.6 m)	14.8 ft. (4.5 m)
Medium (51°)	9.5 ft. (2.9 m)	14.3 ft. (4.4 m)	19.1 ft. (5.8 m)	23.8 ft. (7.3 m)
Flood (69°)	13.7 ft. (4.2 m)	20.6 ft. (6.3 m)	27.5 ft. (8.4 m)	34.4 ft. (10.5 m)

Super Spot/No Lens Performance at any distance:

$$\text{Footcandles (or lux)} = 1,340,000 \div \text{Distance}^2 \quad \text{Beam Diameter} = \text{Distance} \times 0.11$$

Spot Lens Performance at any distance:

$$\text{Footcandles (or lux)} = 382,500 \div \text{Distance}^2 \quad \text{Beam Diameter} = \text{Distance} \times 0.20$$

Medium Lens Performance at any distance:

$$\text{Footcandles (or lux)} = 154,500 \div \text{Distance}^2 \quad \text{Beam Diameter} = \text{Distance} \times 0.30$$

$$\text{Beam Diameter} = \text{Distance} \times 0.46$$

Wide Lens Performance at any distance:

$$\text{Footcandles (or lux)} = 52,350 \div \text{Distance}^2 \quad \text{Beam Diameter} = \text{Distance} \times 0.58$$

$$\text{Beam Diameter} = \text{Distance} \times 0.87$$

Super Wide Lens Performance at any distance:

$$\text{Footcandles (or lux)} = 32,350 \div \text{Distance}^2 \quad \text{Beam Diameter} = \text{Distance} \times 0.94$$

Frosted Lens Performance at any distance:

$$\text{Footcandles (or lux)} = 22,500 \div \text{Distance}^2 \quad \text{Beam Diameter} = \text{Distance} \times 0.96$$